

# Random

*Design: Neuland Industriedesign*



## *Description*

Wall unit composed by Random box and Random cabinet.

**Random Box:** comes with compartments closed by doors made of medium-density wood fibre boards with matt lacquer (micro-goffered) white; uprights and shelves in thickness 1/4"; doors in thickness 1/2". The back is made from white melamine coated board (thickness 3/8"). Open compartments, or closed by doors in standard size, and one drawer compartment. The fixed shelves are fit into the back through concealed dovetail slots.

**Random Cabinet:** storage unit made of medium-density wood fibre boards, with matt lacquer (micro-goffered) in white; uprights, shelves and doors in thickness 1/2". The back is made from white melamine coated board (thickness 3/8"). Compartments closed by doors in standard size. Inner adjustable shelvings. The single unit can always be turned upside down. By flanking more units, this gives the composition a visual continuous or discontinuous pattern. To this end, the plinth is supplied loose so that it can be installed as desired.

The large dims of the compartments and the depth of 13"3/4 allow a functional use of the available space. Adjustable feet to 5/8". By flanking more units, also combining Random Cabinet with Random Box or the standard Random bookcase, elegant large-sized configurations of strong impact can be created. For safety reasons, the unit must be fixed to the wall. It is instead suggested not to fix flanked units together horizontally.

Also, a shim element, only white-lacquered, in depth for the coplanar flanking of Random bookcase with Random Cabinet and Random Box is available upon request.  
Made in Italy.

## *Finishes & Materials*

**Wood structure:** Matt lacquered in white.

\* For more specifications, please refer to the "Finishes & Materials" PDF

## Random

### Dimensions

#### Random Box / Cabinet:

32"1/8W x 13"3/4D x 85"3/8H

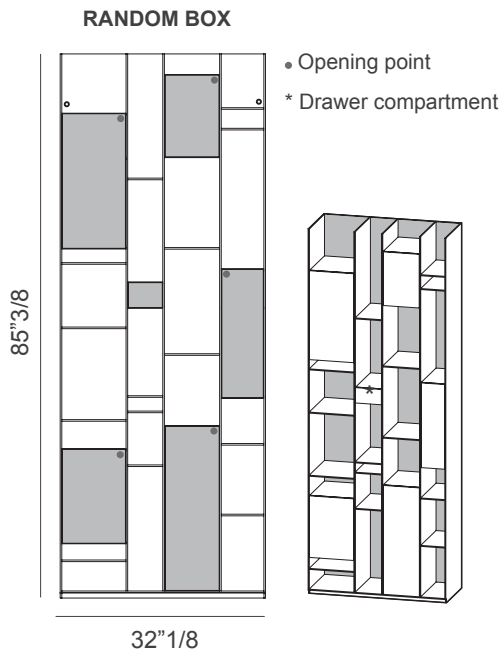

#### Random Bookcase:

32"1/8W x 9"7/8D x 85"3/8H

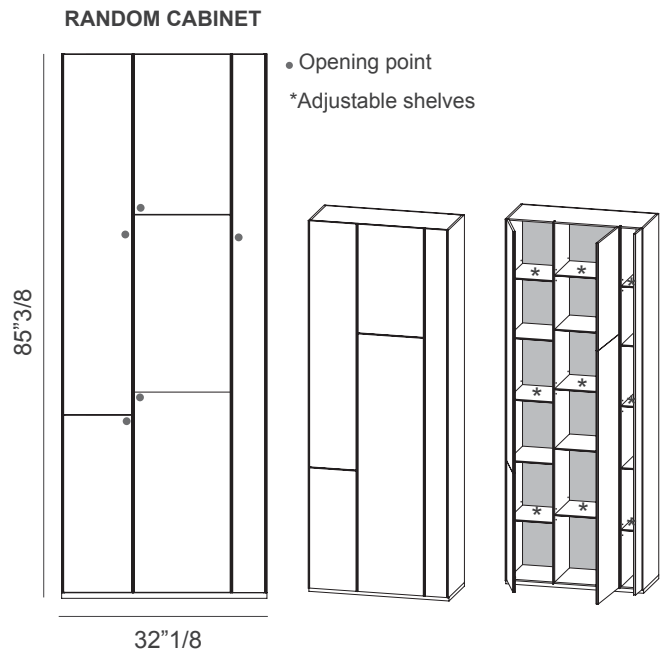

#### OPTINAL SHIM ELEMENT

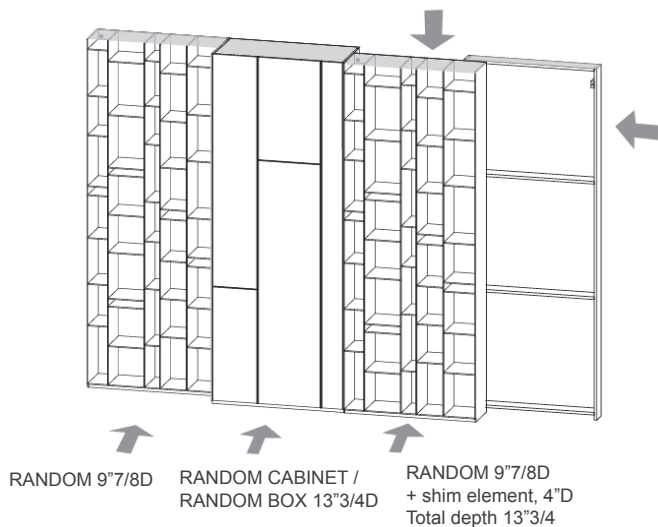

#### RANDOM BOOKCASE

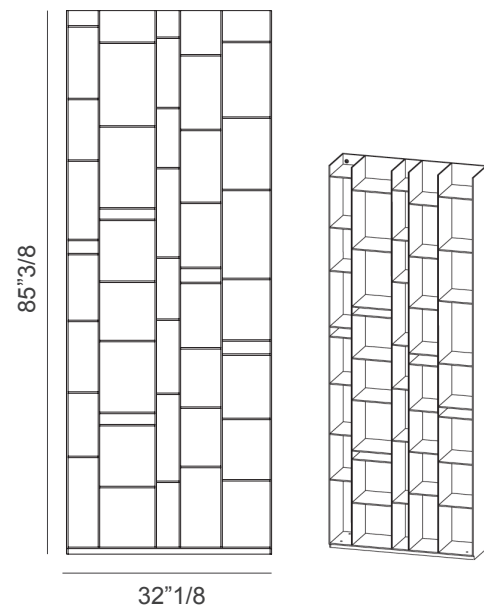

## Random

---

### *Compositions*

#### **Composition A:**

Random Box + Random Cabinet + 2 x Random Box



#### **Composition B:**

Random Box + Random Bookcase + 2 x Random Box



#### **Composition C:**

2 x Random Cabinet + Random Box + 2 x Random Cabinet

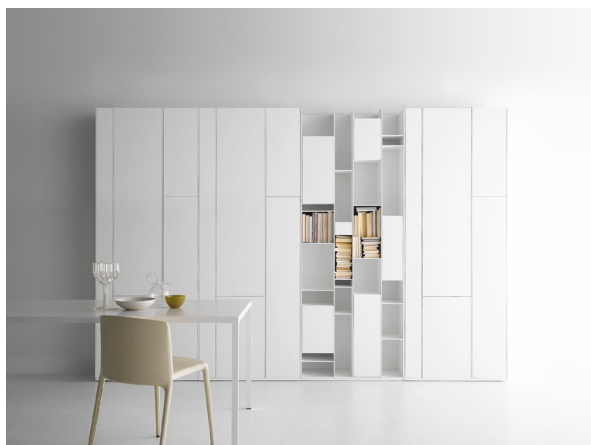

#### **Composition D:**

2 x Random Cabinet + 2 x Random Box

