

## Beetle

*Design: Buseti - Garuti - Redaelli*



### *Description*

Lounge chair with varnished metal base, steel core and injected foam structure. Seat and backrest cushions in polyurethane foam with padding in goose down mixed with frayed polyester fibers or in ECOSY (recycled polyester fibers). Removable covers for the cushions available in fabrics as per collection or customer's own fabric. Non removable covers for the seat and backrest are available in the same fabrics as the cushions or in a mixed version, with sides and outer backrest and seat in leather. A matching footrest is available on demand. Made in Italy.

\* For more specifications, please refer to the "Finishes & Materials" PDF

## Beetle

### Dimensions

30"5/8W x 36"1/4D x 41"H

Seat height: 18"7/8

Armrest height: 23"5/8

Optional footrest:

26"3/4W x 21"5/8D x 17"H

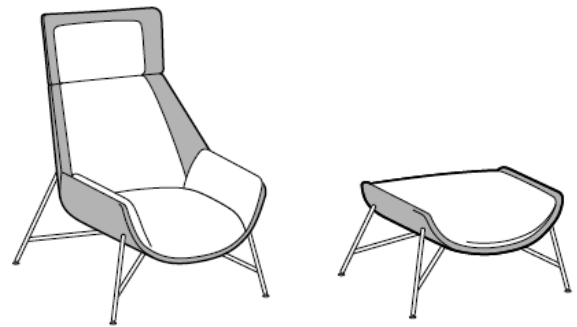
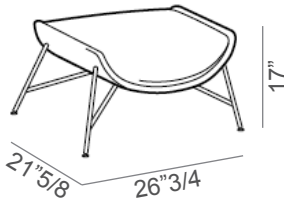
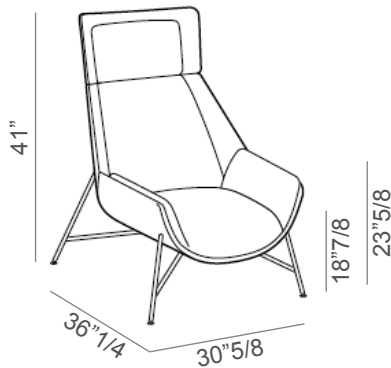

#### Mixed version:

Fabric cushions, sides and outer backrest and seat in leather.

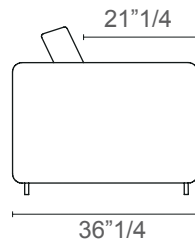
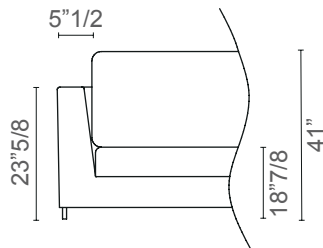

### Internal composition:

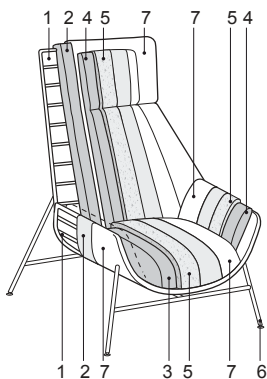

1. Steel structure
2. Injected foam structure
- 3,4,5. Padding
6. Varnished metal base
7. Upholstery

#### Seat

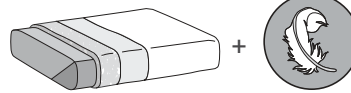

D.35/40kg/m<sup>3</sup>

#### Backrest

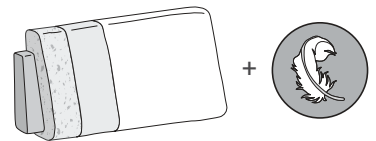

D.30kg/m<sup>3</sup>



ECOSY padding in recycled polyester fibers is an alternative to down padding. Available on demand without surcharge.

\* For more specifications, please refer to the "Finishes & Materials" PDF