

Alchimia

Design: Giorgio Soressi



Description

Structure: Frame in solid wood and multilayer wood, springing system with elastic webbing, padded with non-deformable polyurethane foam and covered with polyester fibre.

Steel feet with bright or black chrome finish.

Seat in non-deformable polyurethane foam and covered with polyester fibre + velveteen.

Dimensions

Terminal unit curved left/right:

80"W x 48"D x 29"1/8H

77"1/8W x 47"1/4D x 29"1/8H

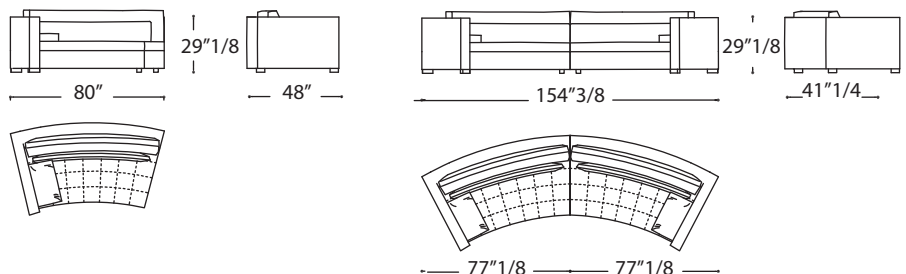

Finishes and materials

Covered in: Fabric (Cat. 1,2,3 and Super) or Leather (A,B,C and Extra).

Feet: Steel with bright or black chrome finish.

(For more specifications, please refer to "Finishes & Materials")