

Neck

Design: Pierangelo Sciuto



Description

Sideboard with 3/4 thick structure made from particle board panels with a matt lacquered or wood veneered finish. Swing doors, available in matt lacquer, wood, metallic lacquer or timewood, with upper grip recesses for 23"5/8 high sideboard, swing fronts with grip recesses for the upper fronts and push-to-open mechanisms for the lower fronts for 44"1/4 high sideboards. The inside of structure is also available with a contrasting matt lacquered or wood veneered finish. The sideboard is supplied with adjustable, 1/2"H concealed feet so that they can stand by themselves on the floor.

Made in Italy.

Optionals:

- . 3000K neutral led light kit (not available with concealed feet).
- . Wooden internal drawers.
- . Transparent methacrylate base / Metal "shuttle" base / "Stilo"base in metal.

Finishes and materials

External structure: Matt lacquer / Wood.

Internal structure: Matt lacquer / Wood.

Doors: Matt lacquer / Wood / Metallic lacquer / Timewood.

(For more specifications, please refer to "Finishes & Materials")

Neck

Dimensions

With 3 swing doors:

73"1/8W x 20"1/2D x 23"5/8H

With 4 swing doors:

96"3/4W x 20"1/2D x 23"5/8H

SIDEBOARD WITH 3 SWING DOORS

including 3 glass shelves

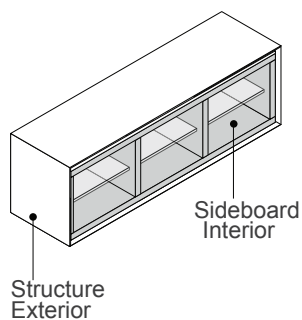
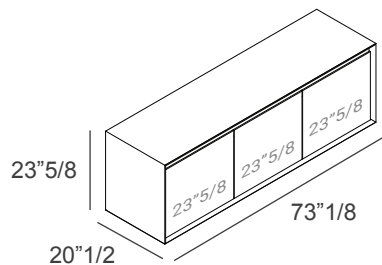

SIDEBOARD WITH 4 SWING DOORS

including 4 glass shelves

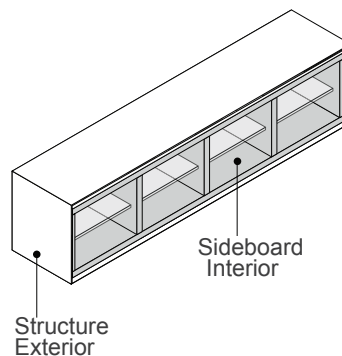
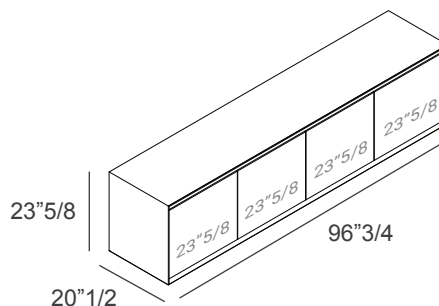

OPTIONAL DRAWERS

WOODEN INTERNAL DRAWER
with side spacers

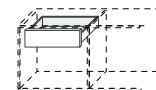

ALUMINIUM INTERNAL DRAWER
aluminium structure with glass
bottom panel with side spacers

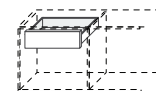

ALUMINIUM INTERNAL JUMBO
DRAWER WITH BOTTLE-RACK
aluminium structure with dividers
with side spacers

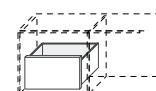

OPTIONS OF BASES

Transparent methacrylate 7"H

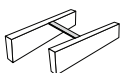

For sideboard 73"1/8W
including one metal
strengthening bar

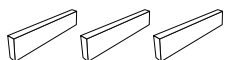

For sideboard 96"3/4W

Metal "shuttle" 6"H

With transparent methacrylate
central foot

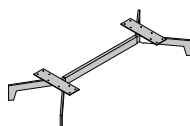

"Stilo" base in metal 7"7/8H

