

Mizu



Description

Suspension lamp with metal structure and crystal diffuser available in five different finishes. Canopy in brushed nickel or white, depending on the diffuser finish. Bulbs are not included. Made in Italy.

Light source

With disc options:

G4 LED 2W. / G4 Halogen 10W.

Integrated LED 1,5W 180 lm 2700K or 3000K - 500mA.

Dimming: Depends on the chosen light source.

With canopy options:

G4 LED 2W. / G4 LED dimmable 3W.

G4 Halogen 10W.

Integrated LED 1,5W 180 lm 2700K or 3000K.

Dimming: Depends on the chosen light source.

Dimensions

4"3/8W x 74"3/4H

Finishes and materials

Diffuser: Nickel, black nickel, brushed bronze or gold plated.

With disc

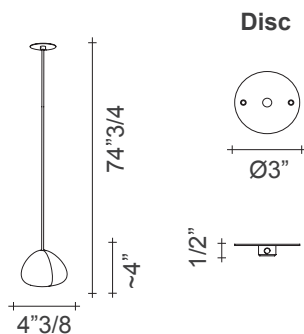

With canopy

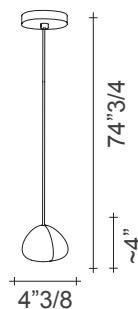

Canopy

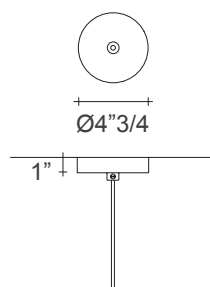

Canopy for DALI

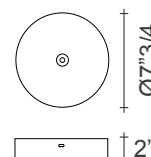

(For more specifications, please refer to "Finishes & Materials")