

# Match

*Design: gherardiarchitetti*



## Description

Cupboard in two models: With 3 swing doors, 2 drawers and 2 glass shelves or with 4 swing doors and 4 glass shelves. 3/4" thick structure and fronts made from lacquered particleboard. One or two doors, depending on the model, come with metal frame characterised by a customized inner panel available in lacquer, wood, glass, mirror, stone or ceramic. Fronts are available in the swing, push-to-open version. Lacquered metal base. Made in Italy.

## Optionals:

- . Wooden internal drawer (not available for the 3 swing doors and 2 drawers model).
- . 3000K neutral LED light kit.

## Dimensions

47"1/4W x 19"5/8D x 52"7/8H

With 3 swing doors  
and 2 drawers

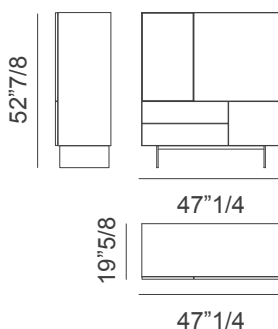

With 4 swing doors

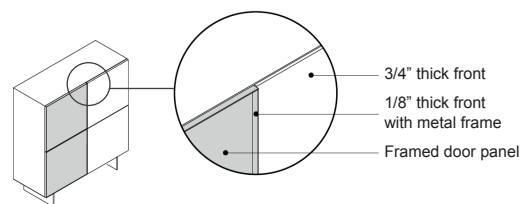
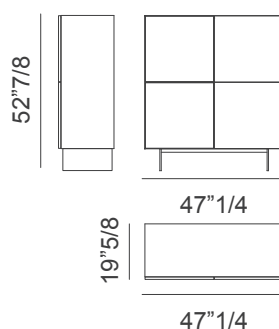

## Finishes and materials

**Structure & Fronts:** Matt lacquer / Gloss lacquer.  
**Frame & Base:** Matt lacquer / Metallic lacquer.  
**Framed door panel:** Matt lacquer / Gloss lacquer / Wood / Glass / Mirror / Stone / Ceramic.

(For more specifications, please refer to "Finishes & Materials")