

Hemingway



Description

Home bar composed by wall unit. Wall unit equipped with on sight tempered glass shelves and LED lights. Working space with trapezoidal decorative insert, tempered lacquered glass top and double sockets. Lower part composed by two compartments with doors and steel handles. Recessed wine cellar for 29 bottles with double zone temperature (46°F-64°F). Bar structure Matt lacquered, shelves structure and lower edge lacquered at choice Matt/Soft Touch/Glossy. Available with or without the frontal counter unit. Made in Italy.

Dimensions

89"1/8W x 21"1/2D x 90"3/4H

Finishes and materials

Working Space Top: Lacquered tempered glass.

Light source: LED.

Structure: Matt lacquered

Shelves Structure & Lower Edge: Matt, SoftTouch or Glossy.

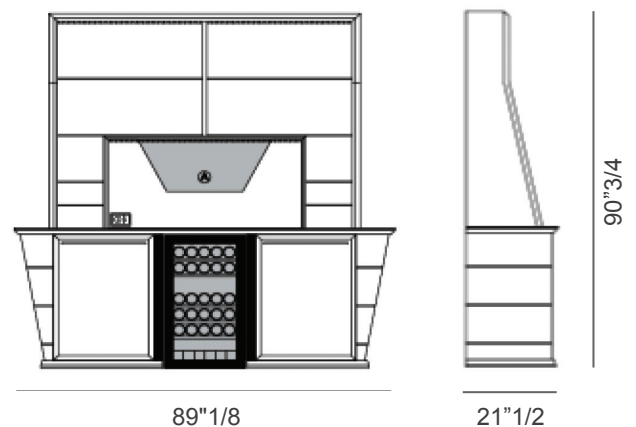

(For more specifications, please refer to "Finishes & Materials")