

Belt

Design: Daniele Lo Scalzo Moscheri



Description

Sectional with structure in solid okumé wood and Dryfeel outdoor foam. Available in single and in bi-fabric version in different colors. Piping in the same fabrics as the back/lower part of the element. This collection is characterized by the possibility to create multiple combinations*.

Made in Italy.

*The size of the compositions could vary by a few centimeters compared to the dimensions indicated, due to the padding that don't allow for precise volumes. For all the compositions proposed, the hardware to link the modules is included.

(For more specifications, please refer to "Finishes & Materials")

Belt

Dimensions

Compositions

Composition 1) 141³/₄W x 82⁵/₈D x 27¹/₂H
Composition 2) 165³/₈W x 92¹/₂D x 27¹/₂H

Composition 3) 185"W x 82⁵/₈D x 27¹/₂H
Composition 4) 185"W x 145⁵/₈D x 27¹/₂H

Composition 1

Single fabric

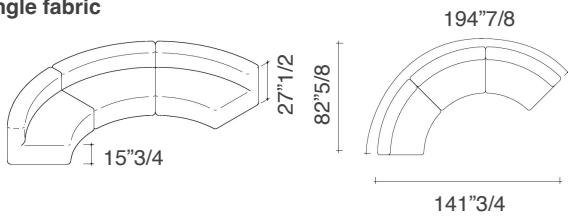

Two-tone fabric

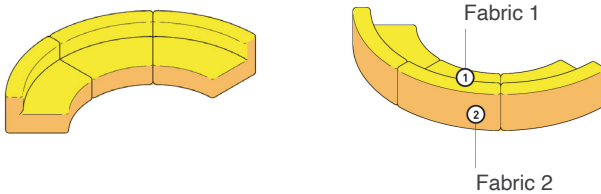

Composition 2

Single fabric

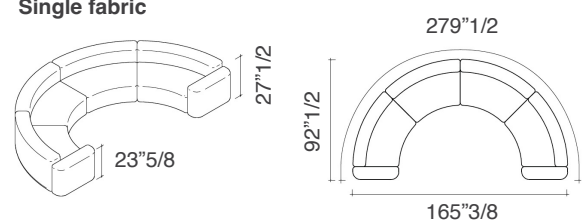

Two-tone fabric

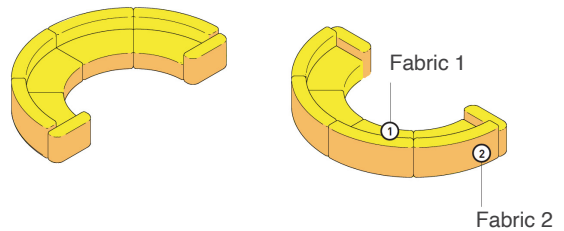

Composition 3

Single fabric

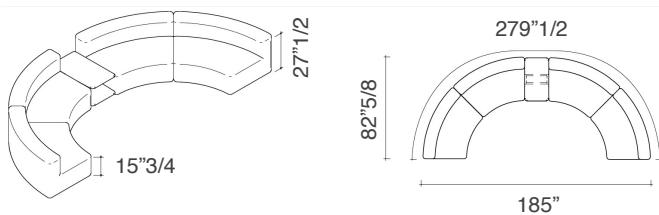

Two-tone fabric

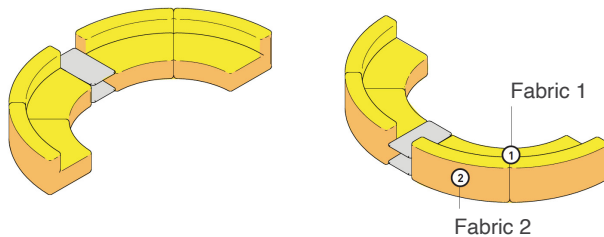

Composition 4

Single fabric

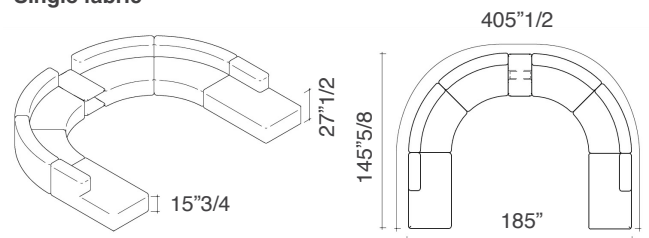

Two-tone fabric

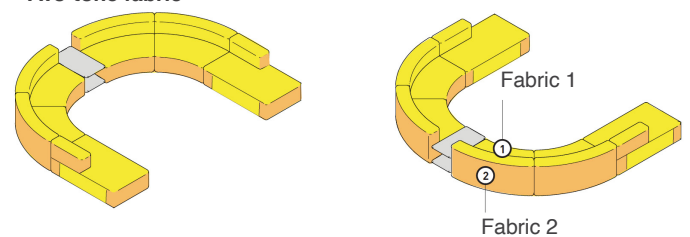

Belt

Dimensions

Compositions

Composition 5) 185"W x 145"5/8D x 27"1/2H

Composition 6) 224"3/8W x 131"7/8D x 27"1/2H

Composition 7) 248"W x 175"1/8D x 27"1/2H

Composition 8) 255"7/8W x 165"3/8D x 27"1/2H

Composition 5

Single fabric

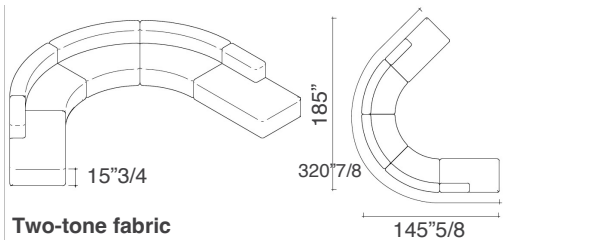

Two-tone fabric

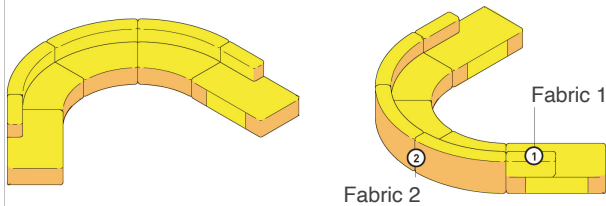

Composition 6

Single fabric

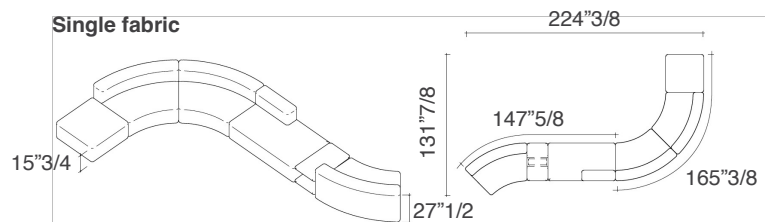

Two-tone fabric

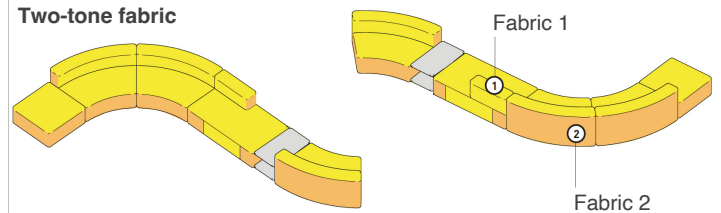

Composition 7

Single fabric

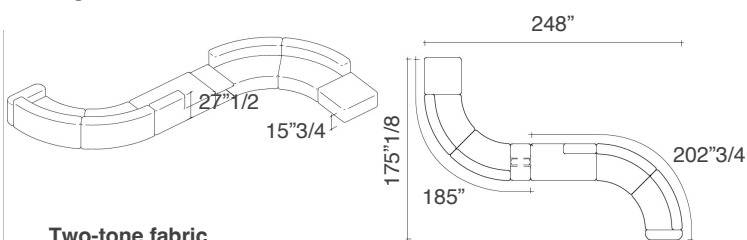

Two-tone fabric

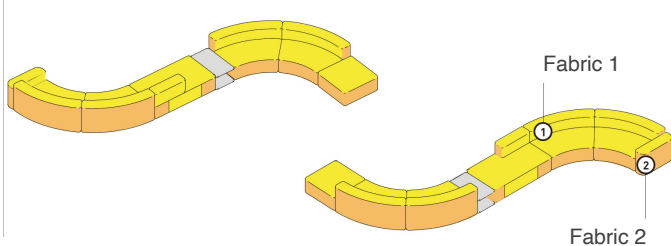

Composition 8

Single fabric

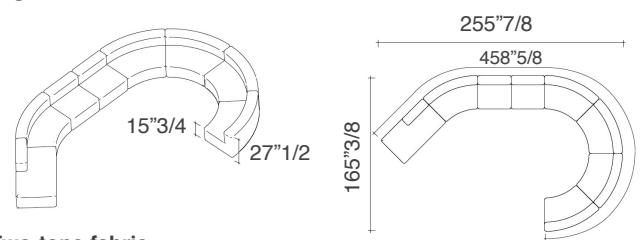

Two-tone fabric

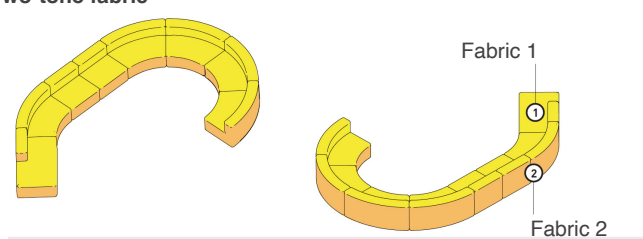

Belt

Dimensions

Compositions

Composition 9) 293"1/4W x 185"D x 27"1/2H

Composition 10) 297"1/4W x 228"3/8D x 27"1/2H

Composition 9

Single fabric

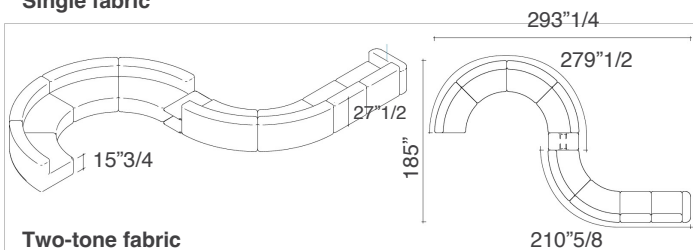

Two-tone fabric

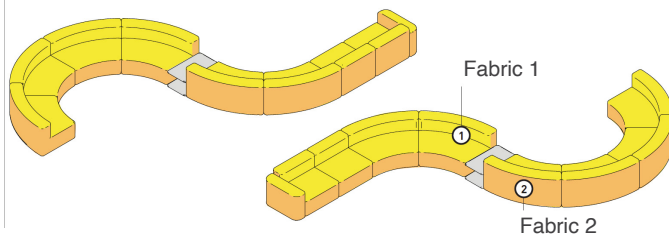

Composition 10

Single fabric

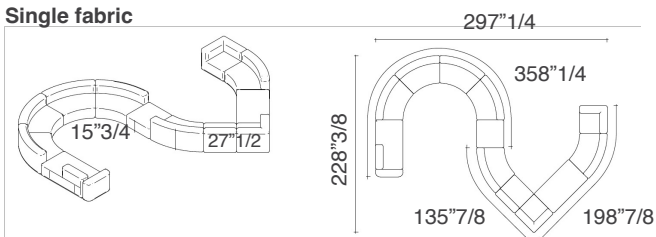

Two-tone fabric

