

UpGlass

Design: Daniele Lago



Description

The transparent effects of the Tempered Glass lighten the look of the imposing structure of the designer UpGlass bedside tables. Functional, highly customizable solutions in luxury XGlass textures, this is a noble material that lasts. It takes on different textured effects thanks to natural finishes such as marble and wood, emphasized by a slick continuous grain which wraps around the units.

The sleek 45° finish is an example of this bedside table's innovative and structurally perfect design, guaranteeing a robust build and timeless beauty.

Furnish your bedroom space flexibly with the UpGlass bedside tables – with no need for any wall fittings.

Made in Italy.

Finishes and Materials

Top & Front: Polished/Matt Glass or XGlass.

Side Panels: Lacquered.

Support: Tempered Glass.

Bottom: Polished or Matt Glass in Grafite finish.

UpGlass

Dimensions

A) 18"3/4W x 16"D x 20"2/8H

B) 22"3/8W x 16"D x 20"2/8H

A)

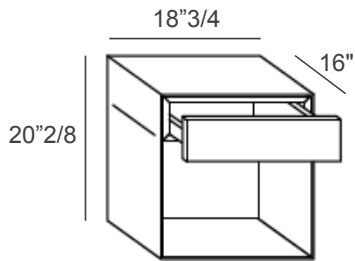

B)

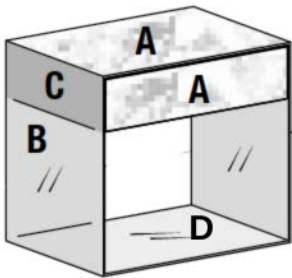
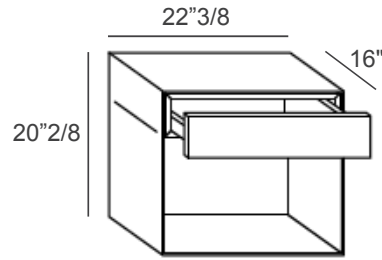

A- Polished/Matt Glass or XGlass.

B- Tempered Glass.

C- Lacquered.

D- Polished/Matt Glass (Grafite finish only).

Finished on the back with lacquered panel 1/8" thick.