

Roll Keramik

Design: Paolo Cattelan



Description

Designed by Paolo Cattelan, the modern tables of the Roll Keramik collection of gives shape to the concept of adaptability, thanks to the countless possible configurations of the bases: 3, 4 or 5 cylindrical legs available in different diameters and elegant finishes. A harmonious play on thicknesses and a perfectly balanced asymmetry give charm and stability to this prestigious design table. The top is made of Marmi ceramic and available in various refined shades, as well as different shapes and sizes. This table allows you to customise every detail of your own fascinating modern living area. Made in Italy.

Technical Information:

Table with titanium or black embossed lacquered steel legs, complemented by refined black chrome steel details. The elegant ceramic Marmi top enhances its luxurious appeal. Available in two versions: the "3" version features one large and two small legs, while the "4" version includes two large and two small legs. An optional additional small leg can be added for extra support. A contemporary statement piece designed for modern interiors.

Roll

Dimensions

Rectangular A: 94"1/2W x 47"1/4D x 29"1/2H
Rectangular B: 118"1/8W x 47"1/4D x 29"1/2H
Oval: 118"1/8W x 59"D x 29"1/2H
Round: Ø62"1/4 x 29"1/2H

Shaped A: 94"1/2W x 47"1/4D x 29"1/2H
Shaped B: 118"1/8W x 47"1/4D x 29"1/2H
Shaped C: 126"W x 54"3/8D x 29"1/2H

Rectangular, Oval, Shaped

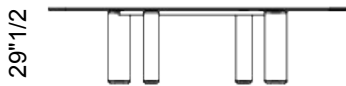

Shaped A

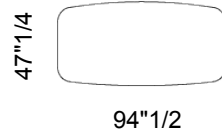

Shaped B

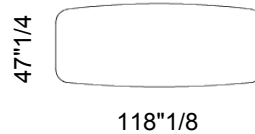

Shaped C

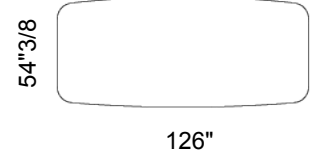

Round

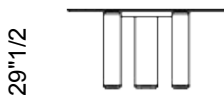

Rectangular A

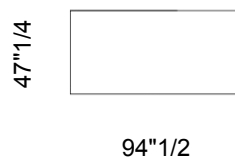

Rectangular B

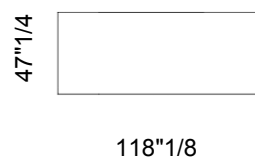

Round

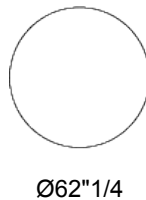

Oval

