

## Glass Up

*Design: R&D Dallagnese*



### *Description*

Glass Up is a refined and contemporary sideboard designed to elevate modern living room furniture with lightness, transparency, and architectural precision. Defined by its elegant metal frame and solid wooden structure, this piece blends functionality with a sophisticated aesthetic, making it an ideal addition to luxury living room furniture settings.

The technological transparent glass doors are equipped with a concealed hinge system that allows an impressive 270-degree opening, ensuring maximum accessibility to the interior. The aluminum door frame, available in brown or black finishes, features subtly protruding vertical profiles that double as integrated handles, combining visual clarity with everyday practicality. The hinged opening is enhanced by a soft-close system with magnet and slow-motion technology, guaranteeing a smooth, silent, and controlled closure.

Available with two, three, or four glass doors, the Glass Up sideboard adapts seamlessly to different spatial and storage needs. Inside, glass shelves reinforce the sense of visual lightness while offering generous and organized storage. Internal built-in LED lighting is offer as optional, and for an added touch of exclusivity, the back panel can be upholstered in regenerated hard leather, enhancing depth, texture, and material contrast. This sideboard is perfectly suited for contemporary living room sets where elegance, transparency, and craftsmanship are essential. Made in Italy.

### *Finishes & Materials*

**Structure:** CARB-02 certified wood particle board panels. Interior in Textured finish.

**Internal Shelves & Doors Front:** Glass.

**Doors Frame:** Aluminum.

**Lama Base:** Metal or Matt Lacquered finishes.

## Glass Up

### Dimensions

- A) Two doors: 35"3/8W x 18"1/4D x 28"3/8H - Cod. GUS0443
- B) Two doors: 35"3/8W x 22"D x 28"3/8H - Cod. GUS0543
- C) Three doors: 53"1/8W x 18"1/4D x 28"3/8H - Cod. GUS0463
- D) Three doors: 53"1/8W x 22"D x 28"3/8H - Cod. GUS0563
- E) Four doors: 70"7/8W x 18"1/4D x 28"3/8H - Cod. GUS1483
- F) Four doors: 70"7/8W x 22"D x 28"3/8H - Cod. GUS1583

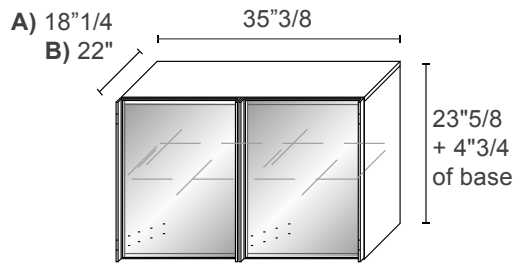

Two doors

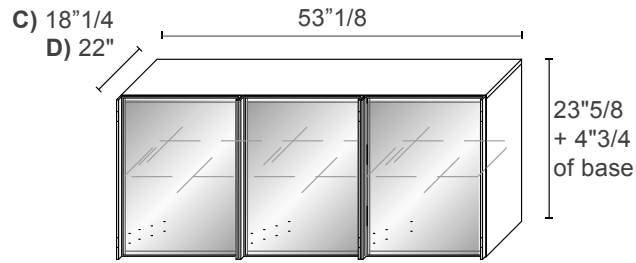

Three doors

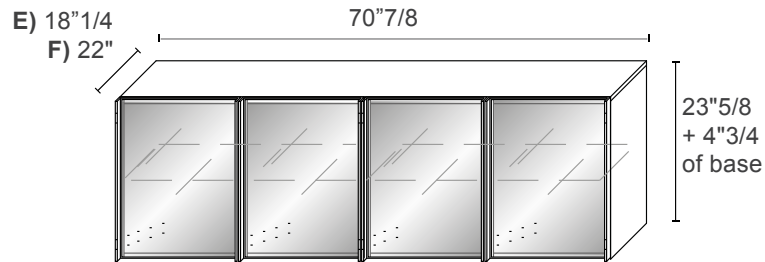

Four doors