

Cut

Design: Daniele Lo Scalzo Moscheri



Description

Lounge chair with steel core and injected foam structure. Swivel base in painted metal. Non removable upholstery in fabrics or leathers as per collection. Matching footrest and headrest are available on demand. Made in Italy.



* For more specifications, please refer to the "Finishes & Materials" PDF

Cut

Dimensions

29"1/2W x 33"D x 42"1/8H

Seat height: 17"

Armrest height: 15"3/4 - 19"5/8

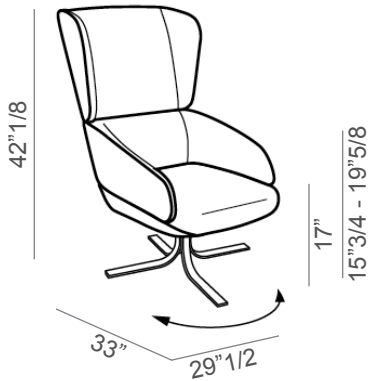

Optional swivel footrest:
24"W x 17"3/8D x 15"H

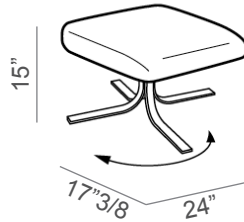

Optional headrest:
14"1/8W x 7"7/8D x 2"3/8H

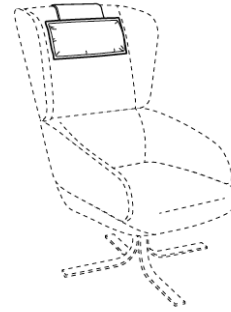

Mix version, with external shell in leather



Mix version, with sides in leather

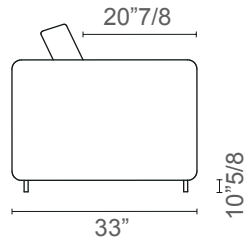
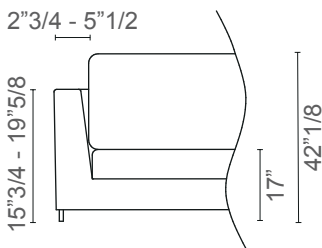

Base



Internal composition:

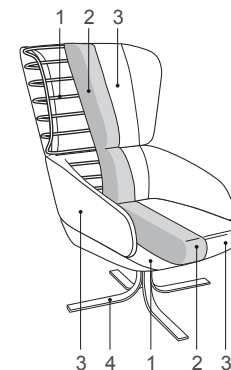

1. Steel structure
2. Injected foam
3. Upholstery
4. Swivel base

* For more specifications, please refer to the "Finishes & Materials" PDF